



Compression Double-Ended Load Cell

# VLC-A121

**APPLICATIONS**

Tank Weighing,  
Truck Scale

**WIRING**

RED	Input (+)
BLACK	Input (-)
GREEN	Output (+)
WHITE	Output (-)

**CAPACITY (T)**

10, 25, 30, 50

**SPECIFICATIONS**

Rated Output	2mV/V ± 0.1%
Non-Linearity	0.03% F.S.
Hysteresis	0.03% F.S.
Non-repeatability	0.02% F.S.
Creep (in 1 hr)	0.03% F.S.
Zero Balance	± 1%
Temp. effect span	15 PPM/°C
Temp. effect zero	26 PPM/°C
Operating Temp. range	- 20°C ~ + 60°C
Compensated Temp. range	- 10°C ~ + 40°C
Input resistance	770 ± 40Ω
Output resistance	700 ± 5Ω
Safe overload	150% F.S.
Ultimate overload	300% F.S.
Excitation voltage	10VDC/AC
Max. Excitation voltage	30VDC/AC
Insulation resistance	≥ 5000MΩ
Environmental protection	IP67
Material	Alloy tool steel
Cable length	50FT



Capacity: 10T, 25T, 30T

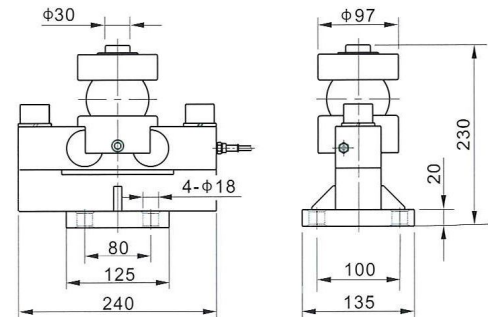

Capacity: 50T

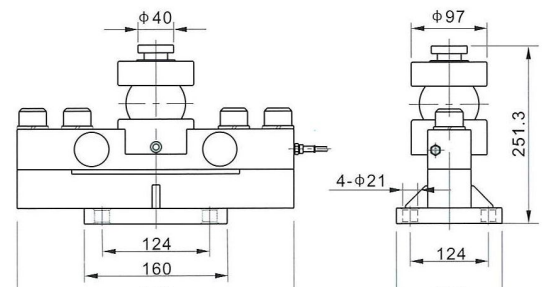

**Virtual Measurements & Control Inc**

196 Coffey Lane, Suite 604, Santa Rosa, CA95403  
Tel: (707) 573 3111 Fax: (707) 573 3113

**Virtual Measurements & Control (Asia) Pte Ltd**

24 Hillview Terrace, Singapore 669235  
Tel: (65) 6762 5522 Fax: (65) 6763 6656

Dealer